

**WALL TO WALL JOINT : CONCRETE WALL TO CONCRETE WALL**

ASSEMBLY RATING = 2-HR.

CLASS II MOVEMENT CAPABILITIES - SEE NOTE NO. 2 BELOW

**FRONT VIEW**

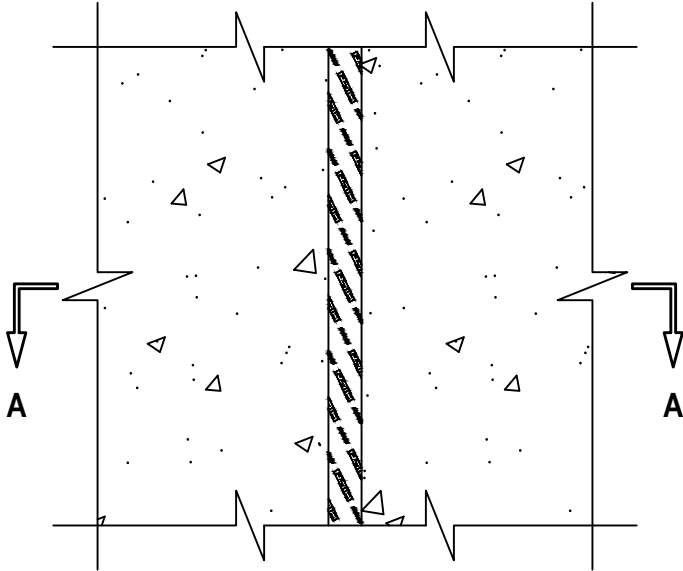

**SECTION A-A**

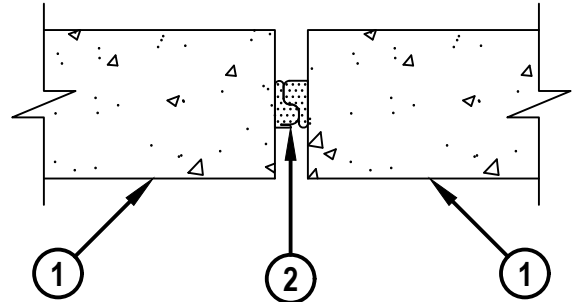

WWD0278b.020723

**1. CONCRETE WALL ASSEMBLY :**

- A. LIGHTWEIGHT OR NORMAL WEIGHT CONCRETE WALL (MINIMUM 4-1/2" THICK).
- B. ANY UL/cUL CLASSIFIED CONCRETE BLOCK WALL.

- 2. HILTI CFS-TTS MD OS OR HILTI CFS-TTS MD 600. BOTH SIDES OF HILTI CFS-TTS MD ARE INSERTED INTO THE JOINT BY ROLLING THE PRODUCT ONTO ITSELF WITH THE OPPOSING CONTOUR ENDS NESTING TOGETHER. THE PRODUCT TO BE INSTALLED FROM EITHER SIDE OF THE WALL CENTERED WITHIN THE WALL. FOR WALLS THICKER THAN 4-1/2", THE PRODUCT MAY BE INSTALLED OFFSET FROM CENTER TO HAVE A MIN 1-1/4" RECESS FROM BOTH SIDES OF THE WALL.**

**NOTES :** 1. WIDTH OF JOINT = MINIMUM 1/2", MAXIMUM 1-1/8".  
 2. MOVEMENT RANGES TO BE DETERMINED AS FOLLOWS :  
 A. FOR MAXIMUM 50% COMPRESSION OR MAXIMUM 12.5% EXTENSION, THE NOMINAL JOINT WIDTH SHALL BE 1".  
 B. FOR MAXIMUM 44% COMPRESSION ONLY, THE NOMINAL JOINT WIDTH SHALL BE 1-1/8".



HILTI, Inc.  
 Plano, Texas USA (800) 879-8000

Sheet	1 of 1
Scale	11/64" = 1"
Date	Feb. 07, 2023

Drawing No.  
**WWD  
 0278b**