

TITLE: EXTENSION & ALTERATION, 5 CHRISTINE ROAD, SIXWORTH, NORFOLK	
PROJECT Ref: 24NO767	DATE: 5/24.
NAME: A	SHEET No: SK01 REV A

PLAN ARRANGEMENT (FURT).

REV A: INTERIOR FLOOR OMITTED.

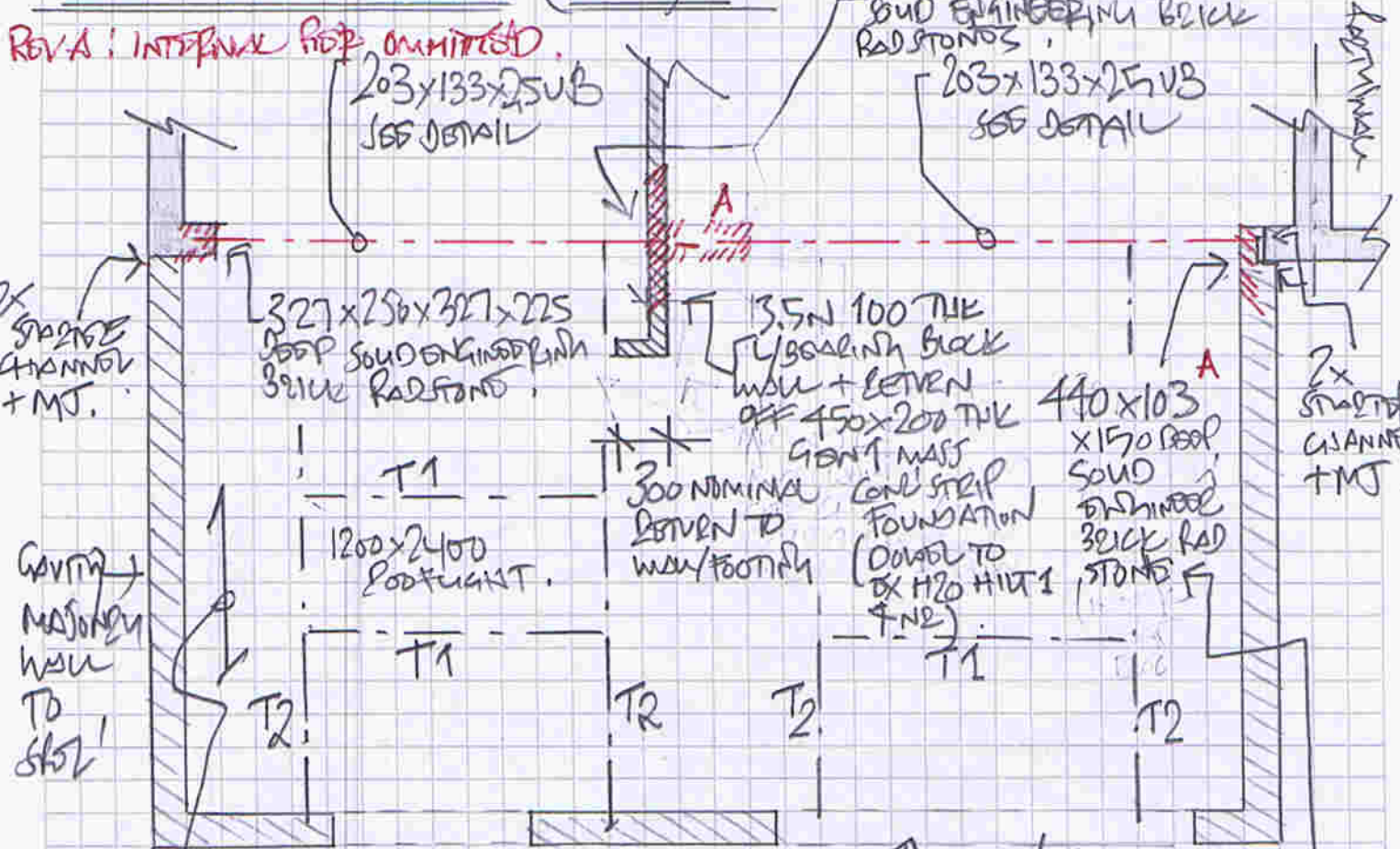

FIRST FLOOR JOISTS
50x175 C24 @ 400 c/c.

← 1x 14 L/STOOD LINTOLS THROUGHOUT.
A (or 203x133x25 SUB BRICK RADSTONS + TL (as above))
INNER LEAF BLOCKWORK EXTENDED EAST + TIED TO EXISTING INNER LEAF MASONRY TO CONTINUOUS GAVIN + FURN L/ROOF NOW PAD STONS.

NOTES:

1. ALL MATERIALS & WORKS IN DETAIL ACCORDANCE WITH BUILDING REGULATIONS, AS SPEC' & WERE NOT BRITISH STANDARDS.
2. READ IN CONJUNCTION WITH THE RELEVANT DETAILS & BEFORE ANY DISORDERING TO EXISTING prior to CONSTRUCTION.
3. CONTRACTOR RESPONSIBLE FOR TEMP WORKS DESIGN & PROVISION TO ENSURE STABILITY OF EX' & PROPOSED CONSTRUCTION DURING WORKS.
4. GROUND CONDITIONS UNKNOWN, MIN 600x250 GENT FOOTINGS TO COMPLY WITH BUILDING REGULATIONS TO WASC INSPECTION/APPROVAL. MIN SAFE SOILING 100 kPa

PORTHOLE TRIMMING LEGEND.

- T1 - 2NE 50x175 C24 SOLID M12 @ 600 c/c
- T2 - 3NE 75x175 C24 SOLID M12 @ 600 c/c

TITLE: EXTENSION & ADAPTATION 5 CHARLTON ROAD, SIXWORTH, NORFOLK	
PROJECT Ref: 24N0767	DATE: 5/24.
NAME: CAM	SHEET No: SK02

T +44 (0)1603 454477
E enquiries@armstrongelliott.co.uk
W www.armstrongelliott.co.uk

246 Unthank Road
Norwich
NR2 2AH
United Kingdom

TYPICAL STEEL BEAM / ROOF SUPPORT DETAIL

FULL LEVEL GROUND
SUPPORT DETAIL

203x133x25 UB WITH SOLID C24
WEB BLOCKING TIGHTLY PACKED
AND SECURED THROUGH BEAM WITH
M12 BOLTS @ 600c/c.

FIRST FLOOR JOIST?
50x175 C24
@ 400c/c

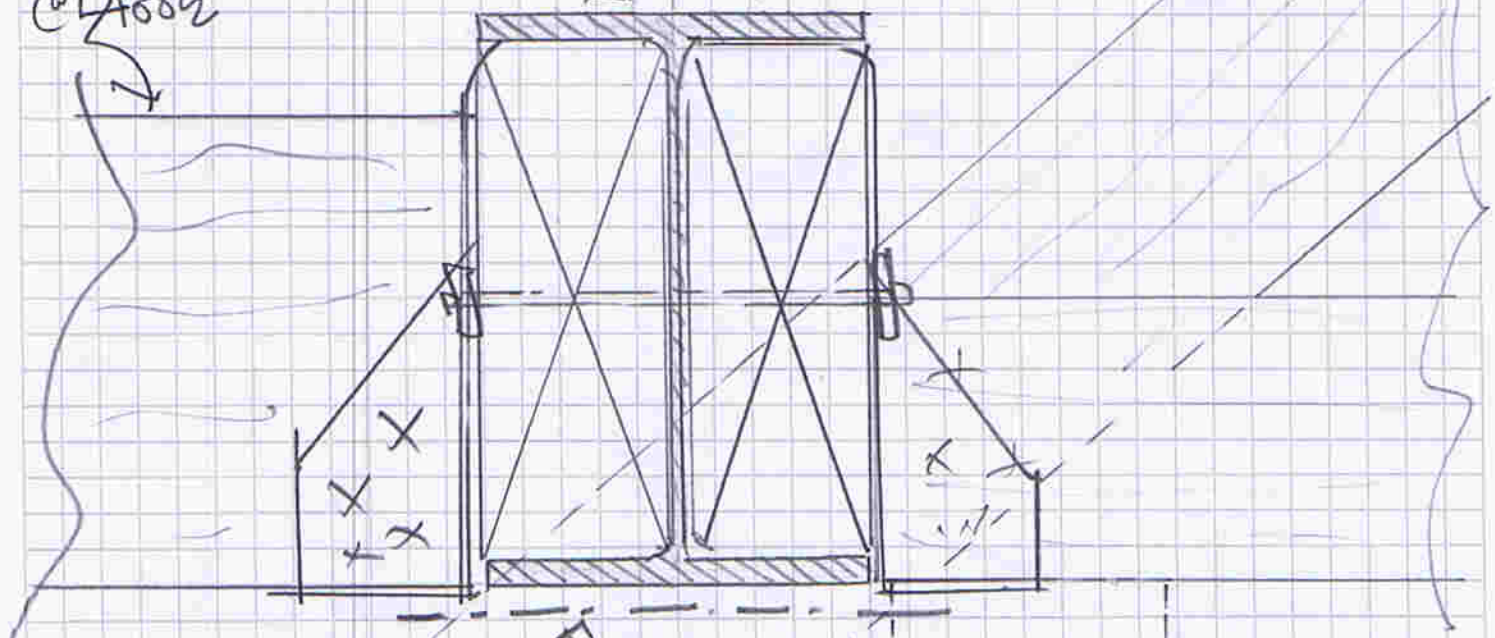

LINE OF EX' MASON
FRONT (CONCRETE)

PROFESSIONAL
FILE UNDER BOARD
TO ADJUST TO ALLOW
BOLTS FIRST
PROTECTION.

CLAMP
AT BACK
DURING
LIFTING
PROTECTION

RESTRAIN EXISTING
BRACE / TRUSS JOINTS
JOINT & CONNECTIONS.

A SUPPORT OF PROFESSIONAL
TOLD FOR HANDING TO STEEL
BEAM C24 WEB BLOCKING.

BEAM PLANNED TO
BASE OF INNER ROOF
BLOCKWORK OVER CAVITY, CLIPS OVER CAVITY
WITH ROOSTERS AS NOTED & SITE CHECK TO CONFIRM EX' CAVITY MATCHING (CONCRETE)

TITLE: EXTENSION & ALTERATION, 5 CHELSEA ROAD, SHERWOOD, NOTFOLK.

PROJECT Ref: 24ND767

DATE: 8/24.

NAME: @v

SHEET No: SK03 BVA



+44 (0)1603 454477
enquiries@armstrongelliott.co.uk
www.armstrongelliott.co.uk

246 Unthank Road
Norwich
NR2 2AH
United Kingdom

BEAM SLICE DETAIL (FORMER BRICK WALL).

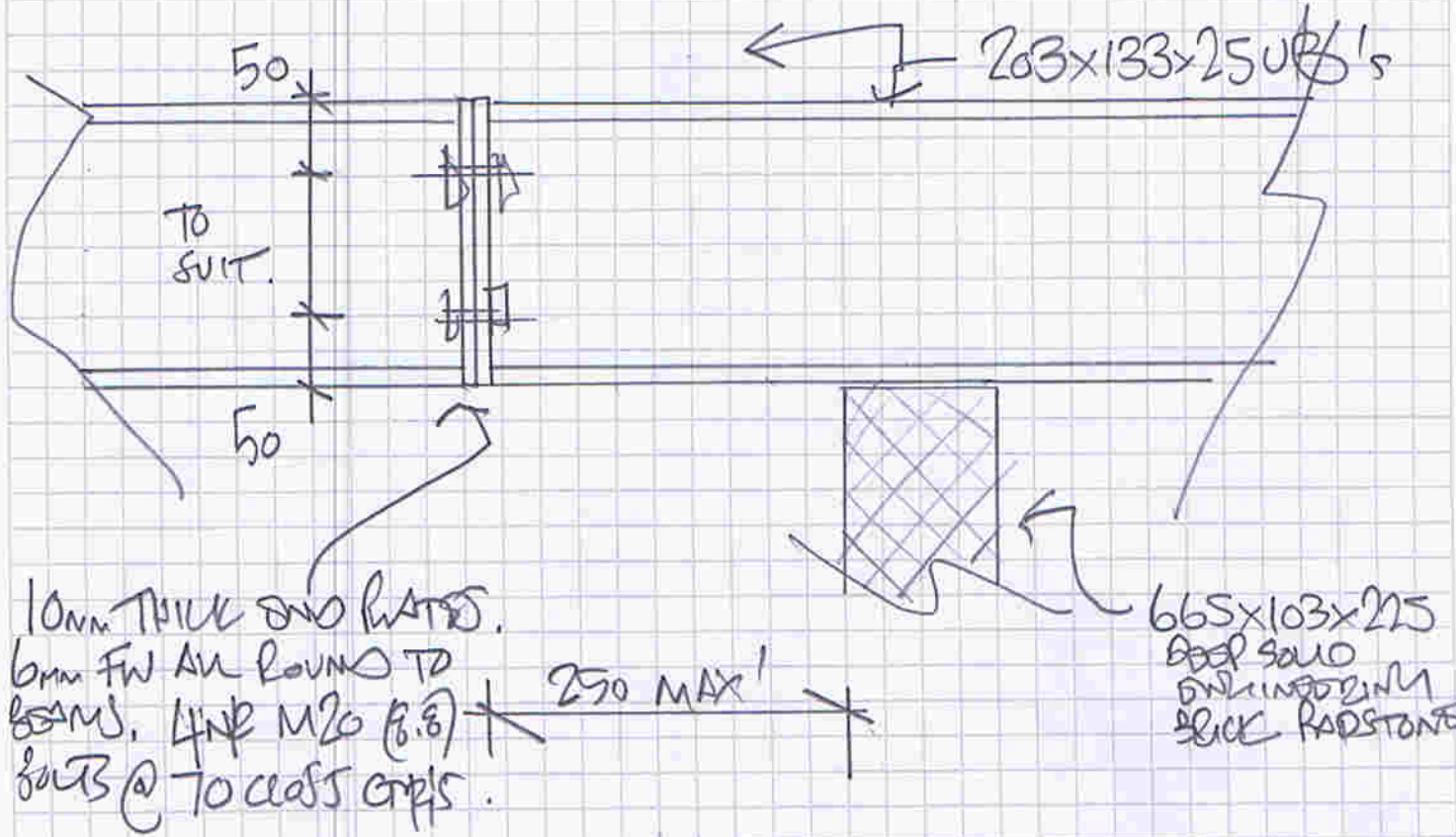

ROOF ELEVATION BRICKWORK UNTIL (BEAM)

203x133x25 UBS + R

225 BATTEN TO DORMERS.

