

2 APPLICATIONS

2.1 Grating fastening system X-FCM and X-FCM NG

X-FCM, X-FCM-M, X-FCM-M_L and X-FCM-M NG grating discs for use with S-BT-GF (NG) M8/7 or S-BT-GR (NG) M8/7

X-FCM-R and X-FCM-R NG grating discs (stainless steel) for use with S-BT-GR (NG) M8/7

A fastening system designed for attaching metal or fiber-glass grating to coated steel.

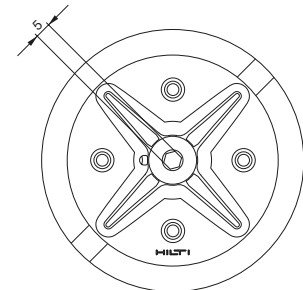
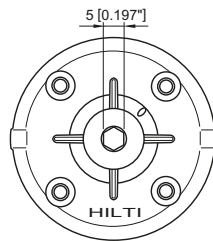
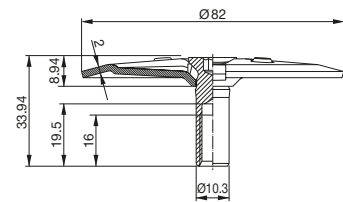
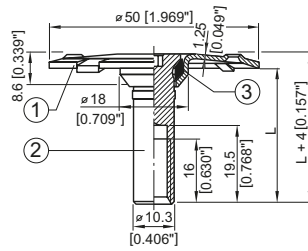
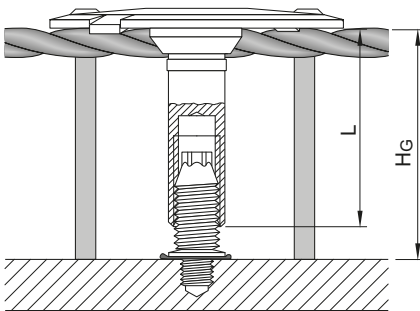

X-FCM, X-FCM-M, X-FCM-R grating discs

X-FCM-M_L grating discs

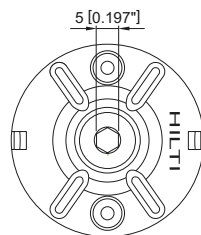
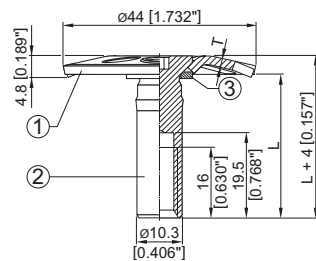

X-FCM-M NG, X-FCM-R NG grating discs

Important: The X-FCM, X-FCM-M, X-FCM-R, X-FCM-M_L, X-FCM-M NG and X-FCM-R NG systems are not designed or intended to resist shear loads.

X-SEA-R 30 M8 extension adaptor

For use with X-FCM-R and X-FCM-R NG grating fasteners for fastening of grating with a height in excess of 50 mm [1.97"].

Fastener Selection X-FCM

Designation	L [mm/in.]	Grating height HG, range [mm/in.]	Grating height with X-SEA-R 30 M8 [mm/in.]
X-FCM-R 25/30	23/0.91	25-30/0.98-1.18	55-60/2.16-2.36
X-FCM-R 1"-1¼"	27/1.06	29-34/1.14-1.34	59-64/2.32-2.52
X-FCM-R 35/40	33/1.30	35-40/1.38-1.57	65-70/2.56-2.75
X-FCM-R 45/50	43/1.69	45-50/1.77-1.97	75-80/2.91-3.15
X-FCM-M 25/30	23/0.91	25-30/0.98-1.18	
X-FCM-M 1"-1¼"	27/1.06	29-34/1.14-1.34	
X-FCM-M 35/40	33/1.30	35-40/1.38-1.57	
X-FCM-M 45/50	43/1.69	45-50/1.77-1.97	
X-FCM-M 31/36 L ¹⁾	25/0.98	31-36/1.22-1.42	

¹⁾ Grating height HG 31 mm and 32 mm: Use with S-BT-GF M8/7 or S-BT-GR M8/7
 Grating height HG 33 mm to 36 mm: Use with S-BT-MF M8/15 or S-BT-MR M8/15

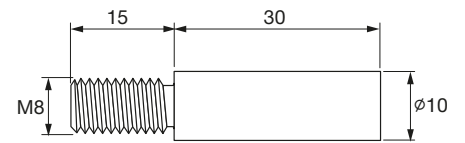

X-SEA-R 30 M8 extension adaptor

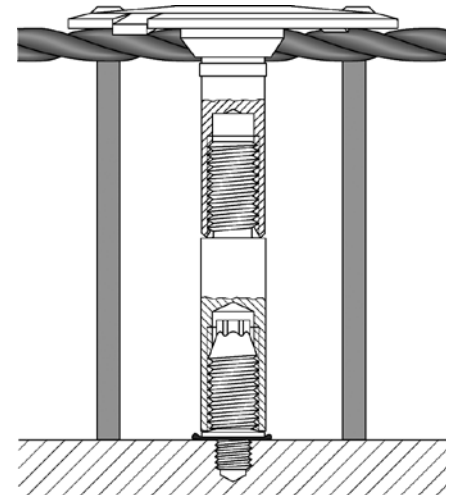

Installation instructions X-FCM

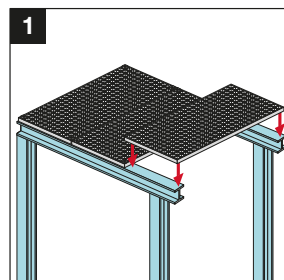

Lay grating section in final position.

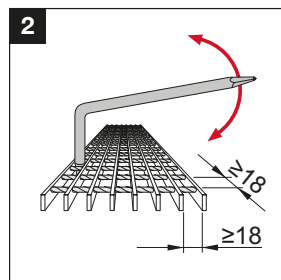

Expand grating openings if necessary.

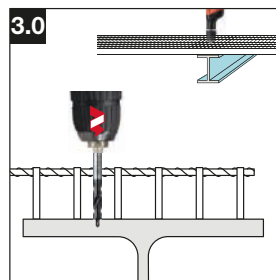

Pre-drill with TS-BT stepped drill bit.

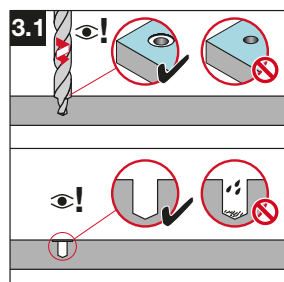
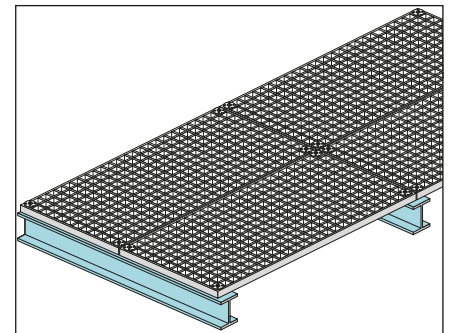

Pre-drill until shoulder grinds a shiny ring. The drilled hole and the area around drilled hole must be clean and free from liquids and debris.

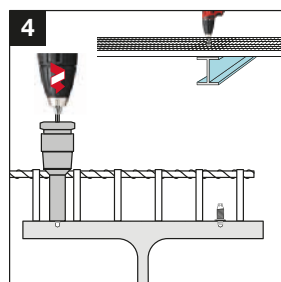

Screw-in S-BT studs into drilled hole.

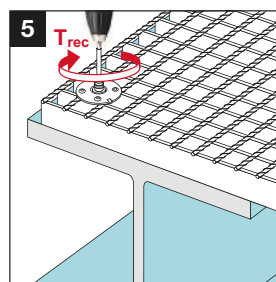

Tighten X-FCM discs with 5 mm Allen-type bit with the suited installation torque.

Fastener Selection X-FCM NG

Designation	L [mm/in.]	Grating height HG, range [mm/in.]	Grating height with X-SEA-R 30 M8 [mm/in.]
X-FCM-R NG 28/33	23/0.91	28-33/1.10-1.30	58-63/2.28-2.48
X-FCM-R NG 32/37	27/1.06	32-37/1.26-1.46	62-67/2.44-2.64
X-FCM-R NG 38/43	33/1.30	38-43/1.50-1.69	68-73/2.68-2.87
X-FCM-R NG 48/53	43/1.69	48-53/1.89-2.09	78-83/3.07-3.27
X-FCM-M NG 28/33	23/0.91	28-33/1.10-1.30	
X-FCM-M NG 32/37	27/1.06	32-37/1.26-1.46	
X-FCM-M NG 38/43	33/1.30	38-43/1.50-1.69	
X-FCM-M NG 48/53	43/1.69	48-53/1.89-2.09	

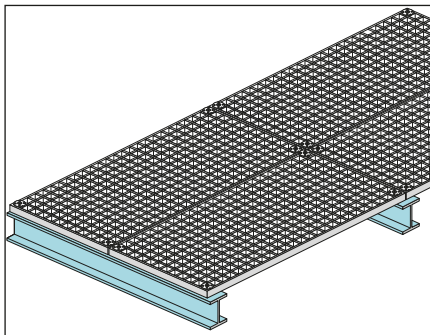

Installation instructions X-FCM NG

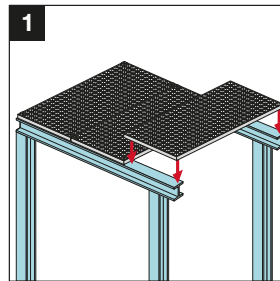

1 Lay grating section in final position.

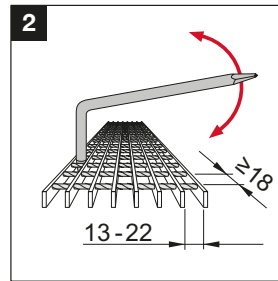

2 Expand grating openings if necessary.

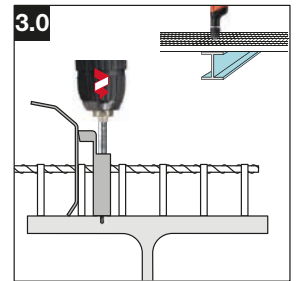

3.0 Pre-drill with TS-BT 5.5-110 S stepped drill bit and S-CS NG centering spacer.

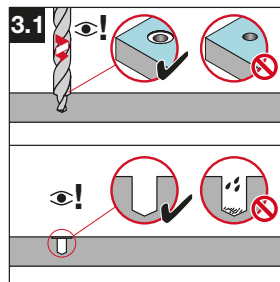

3.1 Pre-drill until shoulder grinds a shiny ring. The drilled hole and the area around drilled hole must be clean and free from liquids and debris.

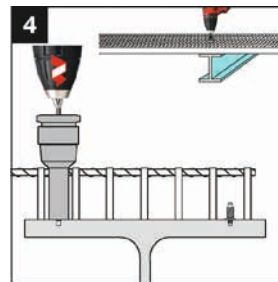

4 Screw-in S-BT studs into drilled hole.

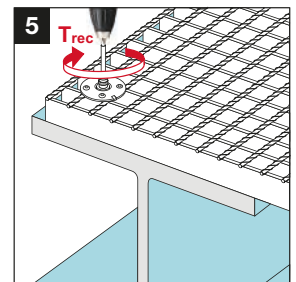

5 Tighten X-FCM NG discs with 5 mm Allen-type bit with the suited installation torque.

Important notes:

These are abbreviated instructions which may vary by application. ALWAYS review / follow the instructions for use (IFU) accompanying the product. In case of a drill through hole, rework of the coating on the back side of the plate / profile may be needed.