

GENERAL NO

REFER TO EXTERIOR ELEVATION
WALL PANEL TYPES AND PATTERNS

EXTERIOR

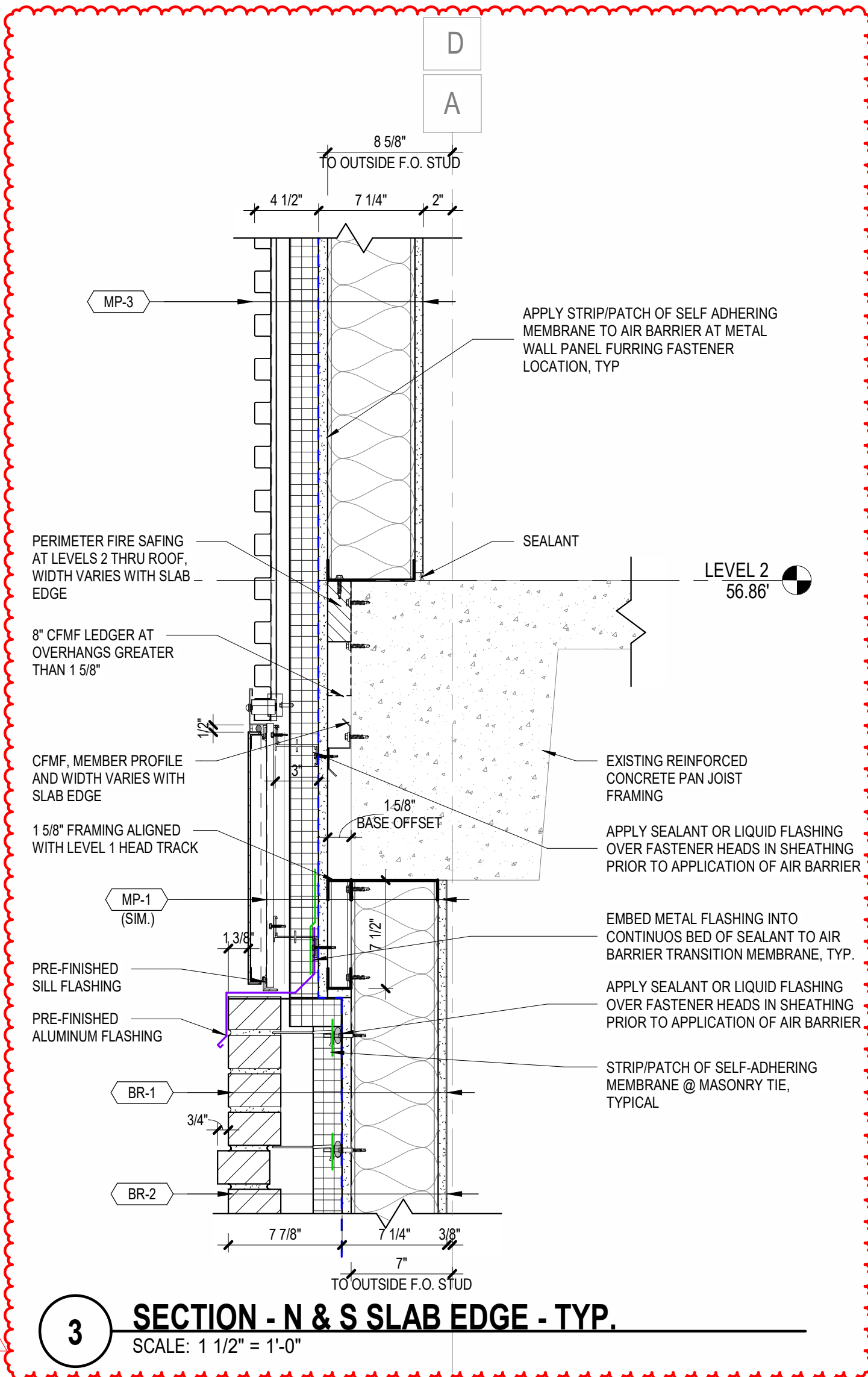

SECTION - N & S SLAB EDGE - TYP.

SCALE: 1 1/2" = 1'-0"

- BR-1 BRICK VENEER**
 - 5/8" GYPSUM WALLBOARD
 - 6" METAL STUD WITH BATT INSULATION
 - 5/8" EXTERIOR SHEATHING
 - FLUID-APPLIED MEMBRANE AND AIR BARRIER
 - MINERAL FIBERBOARD WOOL
 - AIR SPACE
 - 3 5/8" NORMAN BRICK
- BR-2 TEXTURED BRICK VENEER**
 - 5/8" GYPSUM WALLBOARD
 - 6" METAL STUD WITH BATT INSULATION
 - 5/8" EXTERIOR SHEATHING
 - FLUID-APPLIED MEMBRANE AND AIR BARRIER
 - MINERAL FIBERBOARD WOOL
 - AIR SPACE
 - 3 5/8" TEXTURED NORMAN BRICK
- BR-3 BRICK VENEER**
 - 3 5/8" NORMAN BRICK AT SCREEN
- MP-1 MCM PANEL**
 - 5/8" GYPSUM WALLBOARD
 - 6" METAL STUD WITH BATT INSULATION
 - 5/8" EXTERIOR SHEATHING
 - FLUID-APPLIED MEMBRANE AND AIR BARRIER
 - MINERAL FIBERBOARD WOOL
 - AIR SPACE AND METAL PANEL
- MP-2 VERTICAL PROFILED METAL PANEL**
 - 5/8" GYPSUM WALLBOARD
 - 6" METAL STUD WITH BATT INSULATION
 - 5/8" EXTERIOR SHEATHING
 - FLUID-APPLIED MEMBRANE AND AIR BARRIER
 - MINERAL FIBERBOARD WOOL
 - AIR SPACE AND METAL PANEL
- MP-3 HORIZONTAL PROFILED METAL PANEL**
 - 5/8" GYPSUM WALLBOARD
 - 6" METAL STUD WITH BATT INSULATION
 - 5/8" EXTERIOR SHEATHING
 - FLUID-APPLIED MEMBRANE AND AIR BARRIER
 - MINERAL FIBERBOARD WOOL
 - AIR SPACE AND METAL PANEL
- MP-4 HORIZONTAL PROFILED METAL PANEL**
 - 5/8" GYPSUM WALLBOARD
 - 6" METAL STUD WITH BATT INSULATION
 - 5/8" EXTERIOR SHEATHING
 - FLUID-APPLIED MEMBRANE AND AIR BARRIER
 - MINERAL FIBERBOARD WOOL
 - AIR SPACE AND METAL PANEL
- MP-5 MCM SOFFIT PANEL**
 - CFMF FRAMING
 - 5/8" EXTERIOR SHEATHING
 - FLUID-APPLIED MEMBRANE AND AIR BARRIER
 - MINERAL FIBERBOARD WOOL
 - SOFFIT METAL PANEL
- WW1&2 WINDOW WALL - METAL PANEL**
 - IGU-1 - VISION GLASS
- STF01 ALUMINUM STOREFRONT SYSTEM**
 - IGU-1 - VISION GLASS
- RA1 ROOF ASSEMBLY 1**
 - MODIFIED BITUMEN
 - 1/2" COVERBOARD
 - TAPERED POLYISO FOR CRIC
 - POLYISO INSULATION - R-25 L
 - CONCRETE SLAB
 - 5/8" ROOF COVER BOARD ON
- RA2 ROOF ASSEMBLY 2**
 - MODIFIED BITUMEN
 - 1/2" COVERBOARD
 - TAPERED POLYISO FOR CRIC
 - POLYISO INSULATION - R-25 L
 - 5/8" SUBSTRATE BOARD, SUB